



## AC Current Probe Model SR651



The Model SR651 is designed for use in industrial and utility environments. The unique ergonomic design allows it to easily clamp onto cables or small bus bars. It is built to the highest safety and performance standards including the CE Mark and is UL approved.

Excellent transformation and low phase shift, plus a broad frequency response, permit accurate measurements of current for power and power quality measurements. The high quality magnetic cores and uniform windings provide sensitivity for very low level current measurements, as well as measurements up to 1200AAC. The Model SR651 provides an accurate voltage output of 1mV/A. This voltage output enables instruments without current ranges to measure, display log currents through an AC voltage range or measure very low AC.

### Features

- Measurement range of 100mA to 1200AAC
- Large jaw opening accommodates conductors up to two 500MCM conductors
- Improved ergonomic design and easy operation
- Conforms to EN 61010, 600V Cat. III safety standard
- Low phase shift for power measurements
- Available with mA or mV output signals
- Designed for DMMs, recorders, loggers, oscilloscopes, power and harmonic meters
- CE Mark

### Applications

- Power quality measuring
- Low industrial loads
- Measuring around cable bundles
- Power load monitoring
- Waveform analysis

## Specifications

MODEL	SR651
<b>ELECTRICAL</b>	
Nominal Range	1000A
Measurement Range	0.1 to 1200A
Transformation Ratio	Voltage output
Output Signal	1mV/AAC/AAC (1V <sub>AC</sub> @ 1000A)
Accuracy (1000A Range)	≤3% ± 0.1A
1 to 50A	1.5% of Reading
50 to 200A	0.75% of Reading
200 to 1000A	0.5% of Reading
1000 to 1200A	
Phase Shift (1000A Range)	1.5°
50 to 200A	0.75°
200 to 1000A	0.5°
1000 to 1200A	
Overload	1200A for 40 min ON, 20 min OFF
Frequency Range	30Hz to 5kHz; current derating above 1kHz using the formula: 1000A x 1/F (in kHz)
Load Impedance	100kΩ min
Crest Factor	≤6
Working/Common Mode Voltage:	600V Cat. III
Output Termination	Jack
<b>MECHANICAL</b>	
Operating Temperature	-14° to 122°F (-10° to 50°C)
Storage Temperature	-4° to 158°F (-20° to 70°C)
Operating Relative Humidity	0 to 85% @ 35°C
Jaw Opening	2.25" (57mm) max
Maximum Conductor Size	2.05" (52mm)
Maximum Bus Bar Size	One 1.95 x 0.19" (50 x 5mm)
Dimensions	4.37 x 8.50 x 1.77" (111 x 216 x 45mm)
Weight	1.21 lbs (550g)
Polycarbonate Material	Handles: Polycarbonate + ABS, Gray, UL94 V0. Jaws: Polycarbonate, Red, UL94 V0
<b>SAFETY</b>	
Electrical	EN 61010-2-032
CE Mark	Yes

Note: Reference conditions:

23 ± 3°K, 20 to 75% RH, 48 to 65Hz, external magnetic field <40A/m, no DC component, no external current carrying conductor, test sample centered. Load impedance 1Ω.

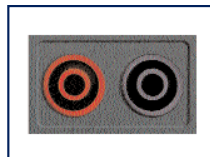
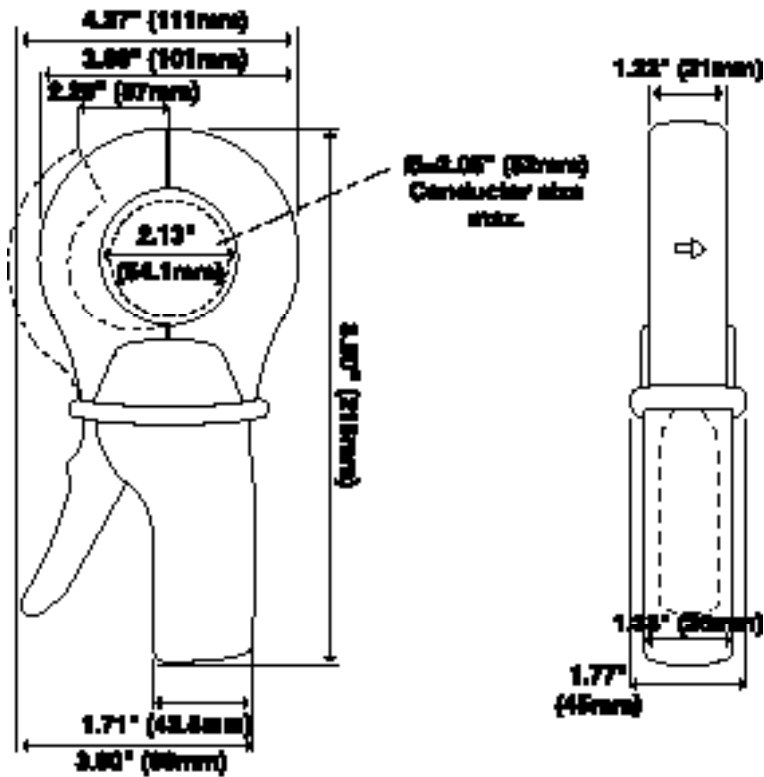

**Jacks:**  
Two standard safety banana jacks (4mm)

ORDERING INFORMATION	CATALOG NO.
AC Current Probe Model SR651 (Jack – 1mA/A – 1000A max) .....	Cat. #2113.45
Includes a user manual	
<b>Accessories (Optional)</b>	
Leads, set of 2, 5 ft safety (1000V) .....	Cat. #2111.29
Banana plug adaptor (Safety Leads to nonrecessed plug) .....	Cat. #1017.45
Banana (Female) – BNC (Male) Adaptor. ....	Cat. #2118.46

## Contact Us

### United States & Canada:

Chauvin Arnoux®, Inc.  
d.b.a. AEMC® Instruments  
200 Foxborough Blvd.  
Foxborough, MA 02035 USA  
(508) 698-2115 • Fax (508) 698-2118  
www.aemc.com

**Customer Support – for placing an order, obtaining price & delivery:**  
customerservice@aemc.com

**Sales Department – for general sales information:**  
sales@aemc.com

**Repair and Calibration Service – for information on repair & calibration, obtaining a user manual:**  
repair@aemc.com

**Technical and Product Application Support – for technical and application support:**  
techinfo@aemc.com

**Webmaster – for information regarding www.aemc.com:**  
webmaster@aemc.com

### South America, Central America, Mexico, Caribbean, Australia & New Zealand:

Chauvin Arnoux®, Inc.  
d.b.a. AEMC® Instruments  
15 Faraday Drive  
Dover, NH 03820 USA  
(978) 526-7667 • Fax (978) 526-7605  
export@aemc.com  
www.aemc.com

### All other countries:

Chauvin Arnoux SCA  
190, rue Championnet  
75876 Paris Cedex 18, France  
33 1 44 85 45 28 • Fax 33 1 46 27 73 89  
info@chauvin-arnoux.com  
www.chauvin-arnoux.com